

## **OWNERS MANUAL for:**

**MODELS: 30032 (Yellow)  
30033 (Blue)  
30034 (Red)**

### **WARNING:**

Read Tecumseh Engine Owner's Manual and Important  
Rules for Safe Operation before Operating Vehicle

### **DANGER:**

**YOU MUST ADD OIL TO THE ENGINE PRIOR TO USE!!!  
20 oz. or 1 ¼ Pints (.6 Liters) OF SAE 30 MOTOR OIL**

This vehicle is sold for OFF-ROAD USE ONLY. Before operating this vehicle, read all the instructions for safe assembly and operation as well as the instructions governing the engine and other portions of the vehicle. Pay close attention to all caution and warning labels on the Fun-Kart.

**For Replacements Parts Call:**

**1-888-926-6554 (U.S.)    1-888-707-1880 (Canada)**



**NOTE: All the items (1-33) below should be read and understood by the Operator and Parent. Failure to follow these instructions could endanger personal safety of the operator and any passenger.**

1. This vehicle is not licensable. **IT IS NOT TO BE OPERATED ON ANY PUBLIC ROAD, STREET, SIDEWALK or ALLEY.** To do so would be a violation of local law. This vehicle may be operated only on private property and upon areas approved by local law.
2. This vehicle should **NEVER** be operated indoors. The exhaust from the engine contains carbon monoxide, which is tasteless, odorless, and poisonous gas.
3. This Fun-Kart is not intended nor designed for racing.
4. **The operator of this vehicle should always wear a D.O.T approved helmet and other protective equipment as recommended by state and local laws. The operator should also wear face shields or goggles, boots, gloves, and other appropriate protective clothing.**
5. Unless otherwise specified in this manual, all screws, nuts, and bolts must be kept tight to ensure that the vehicle is in safe operating condition. The engine must be kept free of all dirt and other accumulations, paying particular attention to throttle linkage area.
6. Prevailing Torque type locknuts lose their locking capability with repeated use and require replacement. Ensure locknuts are functioning properly.
7. The tire pressure should be checked prior to each use. The recommended inflation pressure is the maximum tire pressure which is printed on the tire's sidewall. **Improper tire pressure may cause instability and may prevent proper braking or steering.**
8. Modification of this vehicle or removal of any original equipment or safety decals may render the vehicle unsafe or illegal. **Never remove any chained guard, or belt clutch guard.** These covers are for the riders' protection.

9. The vehicle should never be started without first checking to see that the throttle is in idle position. Do not start engine without verifying proper function of the throttle.
10. **Never attempt to start this vehicle without having the operator sitting in the proper position to ensure control of the kart.**
11. The operator's ability to operate this off-road vehicle safely is largely dependent upon the operator's ability to exercise proper judgment. An operator also must not be too small or too large for controlled operation. The operator must be at least 16 years of age and have understanding, mental capacity and physical capability to safely operate this vehicle. This vehicle should only be operated after mature, supervised instruction and sufficient practice in non-congested areas.
12. **This vehicle is designed for one operator and one passenger.** A passenger on any vehicle must be sufficient age, understanding, mental capacity, and physical capability to act to protect himself/herself, and wear a D.O.T approved helmet at all times. **This kart is not recommended cumulative weights exceeding 250 pounds.**
13. The engine should be stopped when the vehicle is not in use.
14. **Loose clothing, long hair, or articles worn by any riders must be fully contained, or covered to prevent them from possibly being caught in rotating parts of the vehicle or the surrounding environment while riding. Failure to obey could endanger the personal safety of the Riders.**
15. **Do not place hands, feet, or any other part of the body or any clothing near the engine, muffler, wheels, chain, and other rotating parts of the vehicle while riding or running the engine.** Caution must be used in performing required maintenance on or near an operating engine. Special caution should be taken after the engine has been running, since the engine and other drive components may be extremely hot.
16. Wet, slippery, rough, or steep terrain is potentially dangerous and may result in injury if proper caution is not observed. Slow speeds are required to safely operate this vehicle under those conditions. The Operator must use mature judgement, skill, and experience to choose a speed suitable for the terrain and riding conditions.
17. **The Governor settings for this vehicle's engine must not be tampered with, altered or changed.** The governor is set by the engine manufacturer and limits the maximum speed of the engine (and vehicle) and protects the **engine** from damage. Excessive speeds are potentially dangerous to the rider and the engine.
18. Each time before using this vehicle, the fuel supply should be checked. The fuel tank should never be filled while the engine is running or while the engine is hot. Do not fill tank in closed area such as a garage, while smoking, or in the vicinity of an open flame. Do not overfill the tank. Always allow at least ¼ inch of space at the top of the tank for expansion. Never top off tank. Replace cap tightly to prevent spillage of fuel and potential fire hazard. After filling tank, move the vehicle at least 15 feet away from spot of filling before starting.
19. If the vehicle should start making unusual noise or vibrating abnormally, the engine should be stopped and the spark plug wire disconnected. The vehicle should then be checked for damage. Excessive noise or vibration is generally a warning of loose or worn parts.
20. When making repairs or adjustments to the vehicle which do not involve adjustments to the engine, the spark plug wire must be disconnected and kept away from the spark plug to prevent accidental starting. When working on or around or when restarting engine, use extreme caution to avoid contact with the muffler, cylinder head, or any other potentially hot area on or around the engine.
21. Always perform a Pre-Ride Inspection before starting the engine. See Pre-Ride Inspection in the manual.
22. The custom brush guard assembled on this vehicle is for deflecting loose vegetation and must not be removed.

23. When storing the vehicle, it must be kept in a place where gasoline fumes will not reach an open flame or spark. For long periods of storage, such as for winter, the fuel tank should be drained in the open, cool area. The engine must be allowed to cool before storage in any enclosure. Read and keep all printed material supplied with this vehicle. Timely and specific instructions and an Operators Manual revisions are included in supplements. If any printed material included is unclear, please call 1-888-389-5522 for assistance.
24. **Never operate this vehicle while under the influence of alcohol, drugs, or medication of any kind. Such operation could be dangerous to you and/or others.**
25. Always slow down while turning. High speed turning may cause loss of control, possible injury to the Operator.
26. ***Do not race, jump, and perform "stunt" riding or "spinouts" when operating the Fun-Kart. The Fun-Kart is not designed or intended for such operation.***
27. This manual provides guidelines for the assembly, maintenance, and operation of this Fun-Kart and is not intended as a service manual.
28. Assembly, maintenance, and/or repair of this Fun-Kart should only be performed by persons of sufficient mechanical skill, experience, and judgment (such as outdoor equipment dealers, motorcycle dealer/shops, or small engine dealers) so that no unsafe condition or modification is made.
29. Always use extreme caution when starting the engine. Avoid touching the engine, muffler, or drive components. These areas could cause burns on contact.
30. **Operator must always be appropriately supervised at all times while operating this vehicle.**
31. Riding your Fun-Kart requires skill acquired through practice over a period of time. Take the time to learn the basic techniques before attempting to ride the vehicle.
32. Ride only on safe and familiar terrain. Avoid loose gravel and rocks. Be careful on wet surfaces and allow for extra braking distance.
33. ALWAYS mount the caution flag provided on the Fun-Kart for safety purposes. This flag could help prevent dangerous situations.

**Pay close attention to all *Caution* and *Warning* labels on the Fun-Kart.**

## **ASSUMPTIONS OF RISK**

***The Owner Or Operator Assumes All The Risks  
Incident To Or Arising Out Of The Operation Of This Vehicle.  
Failure To Follow And Comply With All Warnings May Cause Serious  
Injury Or Death***

### **YERF-DOG Fun-Karts by Flexible Flyer LIMITED WARRANTY**

**The *Limited Warranty* on this vehicle is in two (2) parts:**

We offer the **original purchaser** of this product the following warranty:

#### ***PART 1***

## **ENGINE**

Tecumseh warrants the engine for (2) years, **NOT Flexible Flyer**. See Tecumseh Engine Owner's Manual. Engine repair, replacement parts, and warranty claims must be handled through an authorized dealer in your locality. Tecumseh has an extensive authorized sales and service dealer network. (See yellow pages of phone directory under "Engine-Gas").

## **PART 2**

### **FRAME**

The frame and related components are warranted by Flexible Flyer and are applied to any part found to be defective due to material and/or workmanship when inspected at the Flexible Flyer factory. Flexible Flyer will at its' option, repair or replace the defective parts to the original purchaser at no charge.

The warranty periods are as follows from the date of purchase:

- A. Frame for 90 days, Void if:
  - 1. Frame is broken or bent due to abuse (underside scraped abusively).
  - 2. Wheels are bent or broken due to impact.
  - 3. Spindles are bent due to impact.
  - 4. Paint is worn off of rear bumper indicating an extra rider.
  - 5. Axels are bent out of ordinary position either horizontally or vertically.
  - 6. Non-Factory altering of engine or it's components.
- B. Bearings and sprocket for 30 days
- C. Clutch for 30 days against breakage of its parts. No warranty is applied for wear of clutch shoes or clutch bearings due to service.
- D. Throttle cable, brake cable, brake band, chain, tires, seat, shocks, fasteners and other components are not warranted because due to normal service they are subject to excessive wear and abuse.

All Warranties are voided if the vehicle has been altered in any way or is used in racing or competition, rented, used under abnormal conditions, or subject to abuse, misuse, neglect, or improper maintenance.

**Flexible Flyer is not liable for any damage claim or liability claim, personal or otherwise resulting from the operation of this vehicle in any way.**

**F.F. Acquisition Corp.  
YERF-DOG Warranty Dept.  
1743 South Horne # 100  
Mesa, AZ 85204**

**FOR REPLACEMENT PARTS PLEASE CALL:  
1-888-926-6554 (U.S.) 1-888-707-1880 (Canada)**

## **ASSEMBLY**

1. Complete the Fun-Kart registration and warranty confirmation on the back of this owner's manual and mail in within 10 days of purchase. The information is required when ordering parts.
2. *Steering Wheel* - Bolt the steering wheel to the anchor plate with fasteners provided in the parts bag included with the Fun-Kart. See "Steering Wheel Assembly Instructions" page 12.
3. *Seat* - Install the seat frame to chassis frame with fasteners provided in the parts bag. See "Seat Assembly Instructions" page 13.
4. *Brush Guard* - Bolt the brush guard to chassis frame with fasteners provided in the parts bag. See "Brush Guard Instructions" page 14.
5. *Foam* - Attach Foam to Brush Guard. See "Foam Attachment Diagram" page 15.
6. *Bolts* - Check the screws, nuts and bolts on your vehicle to see that all are tightened securely. For safe operating conditions, do periodic checks and tighten securely.
7. ***Engine* - Fill the crankcase with oil until it reaches the FULL mark on the dip stick.**  
**DO NOT fill above the FULL mark.** Approximately 20 oz. or 1¼ pints (.6 Liters) of SAE 30 weight oil.  
For additional information refer to Tecumseh engine manual for servicing the engine.
8. Fill fuel tank with regular gasoline, leaded or unleaded. Do not use premium gasoline. Do not overfill (No fuel in filler neck).
9. *Tire Pressure*

## **CHECK AIR PRESSURE IN TIRES!!**

It is common industry practice to over inflate the tires. This is done to guarantee an airtight seal. Prior to riding the Fun-Kart for the first time, you may need to reduce the air pressure in the tires to the specifications stated below:

Rear Tires	10 PSI
Front Tires	12 PSI

Proper tire pressures will increase the life of the tire and enhance the performance of the Fun-Kart. Driving on asphalt or concrete will significantly reduce the life of the tire!!

## **PRE-RIDE INSPECTION**

***WARNING - Perform this pre-ride inspection everyday before riding the vehicle. If not performed, serious damage to the vehicle and personal injury may result.***

1. *Engine Oil Level* – Add oil if required. Check for leaks. Tighten filler cap securely.
2. *Fuel Level* – Add fuel if necessary. Do not overfill (no fuel in filler neck). Replace cap tightly. Check for leaks. Do not mix oil with gas. Only refuel when engine is off and cool.
3. *Brakes* – Perform a Brake Test: Sit in the vehicle with the brake actuated by pressing on the brake pedal. Start the engine with the ignition switch on. Increase the engine RPM gradually to ensure the brake is effective. Do not operate this Fun-Kart unless the brake is working properly.
4. *Tires* – Check conditions and pressure.
5. *Drive Chain* – Check condition, tension, lubricate as necessary.
6. *Throttle* – Check for smooth operation. Assure throttle “snaps” back to idle. Also, check for frayed cable or damaged cable conduit. If either condition exists replace the cable assembly before riding.
7. *Stop Switch* – Perform this stop switch test. While the engine is running, move the steering column remote stop switch to the “OFF” position. If this does not stop the engine, move the engine remote switch to the “OFF” position. If the engine is not equipped with an engine remote switch, pull the spark plug wire. Check to insure that the stop switch wire is attached to the terminal on the engine. **Do not operate this vehicle with a stop switch that is not functioning properly.**
8. *All Nuts, Bolts and Fasteners* – Check wheels to assure that all axle nuts and lug nuts are tightened properly. Check and tighten all other fasteners as necessary. Regularly check set screws on sprockets and drum.
9. *Guards* – Ensure all protective guards are in place. **Never remove any chain guard, or clutch guard.** Each of these covers have a protective purpose, if removed it could endanger the personal safety of the operator or passenger.
10. *Steering System* – Ensure that it turns freely.

## **STARTING INSTRUCTIONS**

***NOTE: Do not attempt to start or operate this machine without being completely familiar with all controls necessary to operate this vehicle safely. Do not start the engine before reading and understanding all the rules, warnings, and instructions in this manual.***

1. Before starting the engine, the operator should be seated in the Fun-Kart. If the rider is not seated in the vehicle, it should be placed against a stationary object and started.
2. Do not start the engine before checking to make sure the throttle assembly is in the idle position. Warning – Each time prior to starting the engine, check throttle assembly to ensure that when the throttle pedal (right side) is pushed all the way forward the assembly is working smoothly and returns to idle when released. Do not operate if pedal and engine throttle linkage fail to return to idle.
3. To start a cold engine, pump the engine primer “3” times. If the engine is hot, priming may not be necessary to restart the engine.
4. Pull recoil starter rope sharply. See Tecumseh engine owner’s manual. Do not flood the engine by continuously pulling the starter rope. If engine does not start after two or three pulls of the starter rope, wait a few minutes then repeat the above procedures.

## **OPERATIONAL SAFETY TIPS**

### **TURNING MANUEVERS**

The new rider must learn to shift his weight and control the throttle to allow the rear tires to negotiate the turn. This is the primary technique to be mastered in riding this vehicle. Practice turning at slow constant speeds. Defer increased speeds until you are confident of your proficiency and are intimately familiar with the terrain.

Steer in the direction of the turn, and lean your body to the inside of the turn in order to maximize front tire traction. Use the throttle to maintain posture throughout the turn.

Incorrect turning techniques may cause the front tires to slide straight ahead without affecting the vehicles direction of travel. If this should occur, come to a stop, then resume the technique outlined above.

If the front wheels tend to skid in mud, sand, or snow, you may be able to improve control by releasing the throttle and allowing the vehicle to coast through the turn.

If rear wheel inadvertently skid sideways, correct your slide by steering in the direction of the skid, if you have room to perform this maneuver safely. Avoid braking or accelerating until you have control.

To avoid skids while traveling on slippery terrain, the rider must exercise a high degree of caution. Turning maneuvers on slippery terrain are more hazardous than those performed under full traction and must be done slowly.

## **PREVENTIVE MAINTENANCE**

### **STORAGE**

In the event your vehicle is not to be operated for a period in excess of 30 days and at the end of riding season prepare for storage as follows:

**WARNING - Do not drain fuel while engine is hot. Be sure to move vehicle outside before draining fuel.**



1. Drain fuel tank and remove all fuel remaining in the tank by using a suction device or by soaking up the fuel with a clean rag or towel. Remove all fuel remaining in the carburetor by allowing engine to run out of fuel. Do not perform any fuel removal procedure while smoking or near an open flame. Dispose of any rags or towels properly.
2. Lubricate engine cylinder by removing the spark plug and pouring an ounce of lean lubricating oil through the spark plug hole into the cylinder. Crank the engine slowly to spread oil and replace spark plug.
3. Do not save or store gasoline over winter. Using old gasoline that has deteriorated from storage will cause hard starting and affect engine performance.
4. When the vehicle is removed from storage re-read the owner's manual, perform any assembly required, and perform a pre-ride inspection. See Pre-Ride Inspection section of this manual.

## **GENERAL**

Just as your automobile needs professional, mechanical maintenance from time to time, so does this vehicle. Replacement of the spark plug and ignition points is made necessary by normal use. Professional air-cooled engine service is easily obtained. Check your phone book yellow pages under "Engine Gasoline".

## **SERVICE INSTRUCTIONS**

*Engine Lubrication* – You must change the oil in the crankcase after the first two hours of operating your new engine and after each 25 hours of use thereafter. That will insure proper lubrication in internal parts and prevent costly repairs due to excessive wear. Refer to Engine Maintenance Instructions.

*Kart Lubrication* – Every two or three hours of use lubricate the following items with several drops of oil; steering bearing points, brake rod pivot points, pedal pivot points, steering spindles, and steering rod ends. Use the same grade of lubricating oil that is used in the engine crankcase.

*Chain Lubrication* – **For the best chain life, it should be lubricated with a graphite type of lubricant such as the spray-on type which evaporates leaving the graphite on the chain.** Using oil or grease on the chain in dusty or sandy riding conditions may cause dirt particles to stick to the chain resulting in rapid wear from abrasion.

*Front Wheel Replacement* – Care must be used when replacing wheels. **Do not over tighten nuts.** It is only necessary to tighten the nuts so that the wheel turns freely on the axle with minimum endplay. If the wheel does not turn freely the nut is too tight.

*Rear Wheel Replacement* – Loosen the large locknut in the center of the wheel to remove the rear wheel.

*Chain Adjustment* – After the first two hours of operation, check the chain adjustment and readjust it if it has more than 1/2" flex. Loosen the engine clamp nuts and slide the engine forward to tighten chain.

## **For Replacement Parts Please Call:**

1-888-926-6554 (U.S.) 1-888-707-1880 (Canada)

## SUSPENSION MAINTENANCE

The Suspension System on your Fun-Kart is specifically designed and set up for the smoothest possible ride, while maintaining top performance and kart durability. Your Fun-Karts suspension system uses four shock absorbers, two on the front suspension and two on the rear suspension, to comfortably tackle rough terrain.

The two front shock absorbers affect the camber or slant of your front tires. You may have noticed that your new Fun-Kart has an *extreme outward camber* or slant of the front tires as shown in **Figure A** **This is normal**. They were set this way at the factory for ensuring maximum tread life on the front tires. There are three important reasons for this outward camber:

**1. The weight of the driver and/or passenger is not on the Kart.**

The added weight of the driver and/or passenger pushes the front and rear suspension down.

**2. The Fun-Kart is not in motion.**

When the Kart is in motion, the front suspension is forced down slightly.

**3. The shock absorbers are new and not “broken in”.**

Your new Fun-Kart needs at least one hour of use to “break in” the shocks and level out the tires. After the first 30 minutes of use, the outward camber may be reduced by one half. After 1 hour of use the tires may have *almost no or slight outward camber* as shown in **Figure B**.

When your Fun-Kart gets an *inward camber* on the front tires from shock wear as shown in **Figure C** and steering becomes difficult, the shocks will need to be readjusted. Adjust the front suspension to a *slight outward camber* as shown in **Figure B** by increasing the shocks. Adjust the shocks by following the “Shock Absorber Adjustment “ instructions below. When your shocks cannot be adjusted any tighter, they must be replaced.

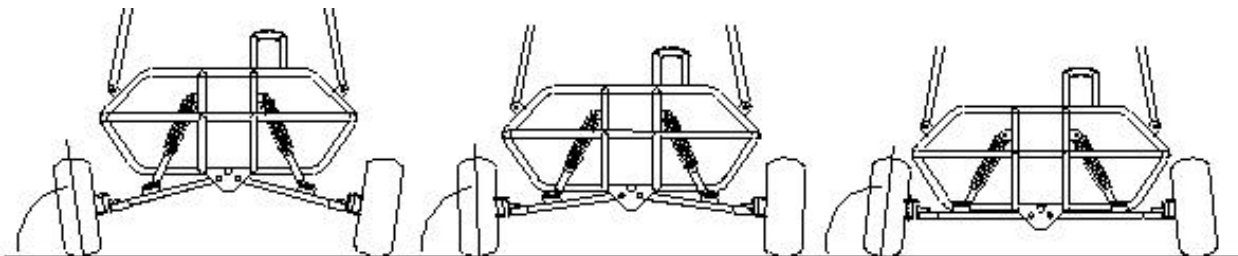

**A. EXTREME OUTWARD CAMBER**

(NEW SHOCKS, NOT BROKEN IN)

**B. SLIGHT OUTWARD CAMBER**

(SHOCKS BROKEN IN)

**C. INWARD CAMBER**

(SHOCKS NEED TO BE  
ADJUSTED OR REPLACED)

Your Fun Kart has an added feature on the A-Arms for three quick Camber Adjustments **Figure D**. Note: The factory attaches the shocks at position 2. You may choose to move them to position 1 and adjust shocks to set at Slight Outward Camber (Riding Position) until the shocks “break in” then either readjust the shocks as shown in

“Shock Absorber Adjustment” or move to position 2. Shocks may bottom out (cannot be adjusted any tighter) before you need to set to position 3.

To adjust: Remove 3/8” x 1-3/4” Bolts and 3/8” Nylock Nuts attaching the bottom of the Shocks to the Three Hole Brackets and move to desired hole then reattach Shocks. Tighten Bolts.

**NOTE:** Outside holes can be used for new kart display purposes with new shocks. (Setting at “NO CAMBER”)

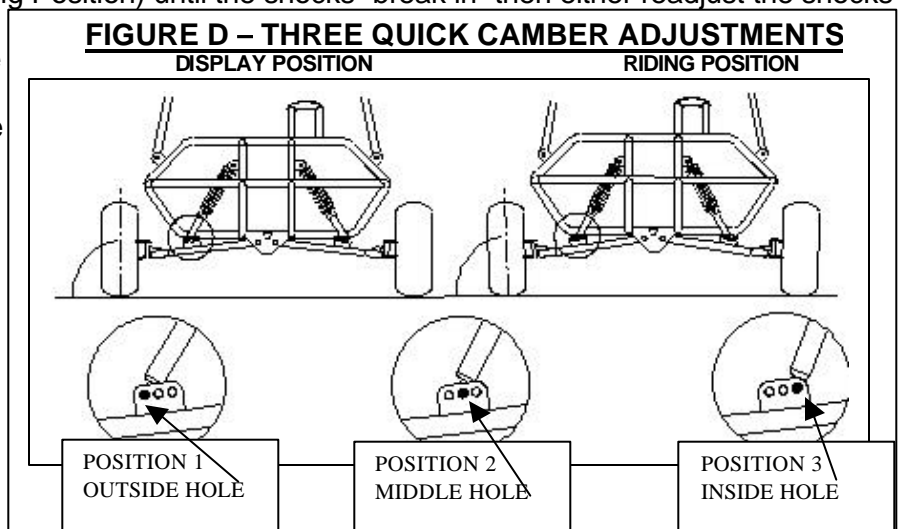

## SHOCK ABSORBER ADJUSTMENT

1. Locate the SHOCK ABSORBERS (74) at the front and rear of the FUN-KART.
2. The factory pre-set the SHOCKS for normal operating conditions.
3. Locate the SHOCK ADJUSTMENT HOLE at the base of the spring.
4. Place the end of a narrow screwdriver in the SHOCK ADJUSTMENT HOLE.

5. Turn the SHOCK ADJUSTMENT HOLE counter-clockwise around the SHOCK to decrease shock absorption.
6. Turn the SHOCK ADJUSTMENT HOLE clockwise around the SHOCK to increase shock absorption.
7. Experiment with the adjustment until the desired effect is attained.

## STEERING WHEEL ASSEMBLY INSTRUCTIONS

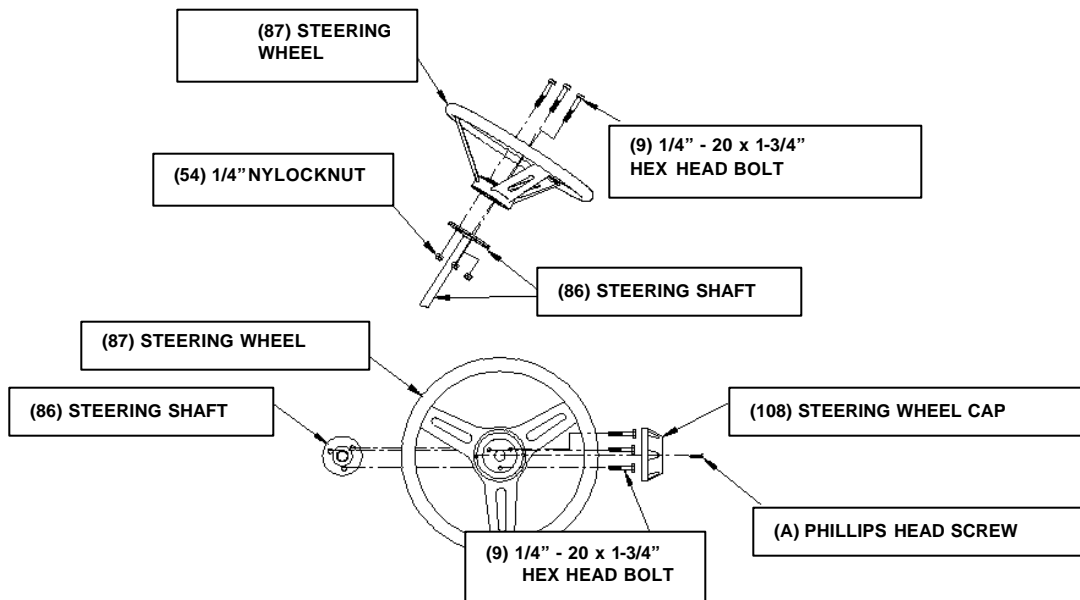

### STEERING WHEEL HARDWARE

Item	Description	Qty
9	BOLT, 1/4"-20 X 1- 3/4"	3
54	NUT, 1/4" - 20	3
108	STEERING WHEEL CAP	1
A	SCREW	1

## SEAT FRAME ASSEMBLY INSTRUCTIONS

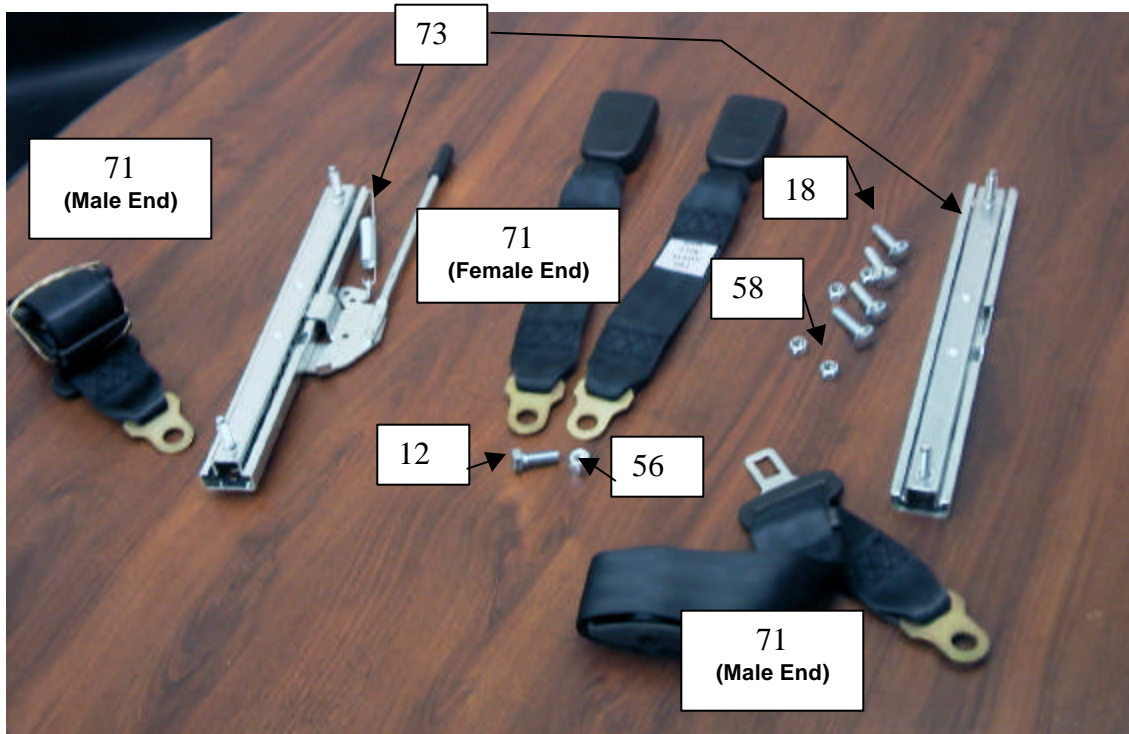

For ease of assembly, lay the seat frame on a table, seat back plate down, and seat bottom coming up away from the table.

### SEATBELT ATTACHMENT HARDWARE

<u>Item #</u>	<u>Description</u>	<u>Qty</u>
12	BOLT;3/8-16 X 1" HEX	1
18	BOLT;5/16-18 X 1-1/2 CARRIAGE	4
56	NUT;3/8-16 NYLOCK	1
58	NUT;5/16-18 NYLOCK	4
71	SEAT BELT; RETRACTABLE	2
73	SEAT RAIL	2

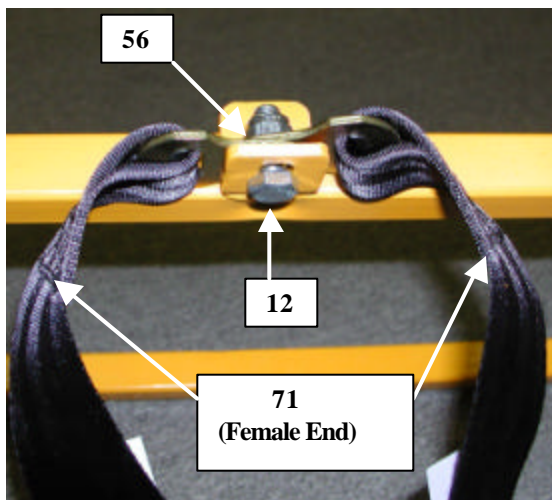

Attach the two female seat belt ends (71) to the tab at the rear center of the seat frame with bolt (12) and nut (56), as shown. Tighten securely.

The seat rail slides can be moved to allow access to the mounting holes in the seat rail.

To move the slide on the rail with the adjustment lever, press outward and down on the lever.



Move the slide of the seat adjustment upward for access to the lower, square-mounting hole. Insert carriage bolt (18) through bottom square hole of seat frame; through mounting hole of

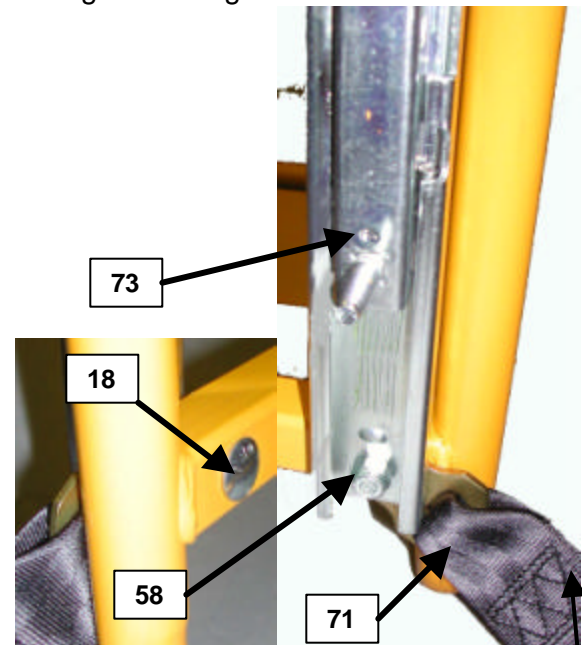

male seat belt (71), and through the seat adjustment rail (73).

Place nut (58) on end of carriage bolt (18) and tighten.

**Note:** Make sure the seat belt is extending to the outside of the seat frame.

## CUSHION ATTACHMENT

**FIRST**

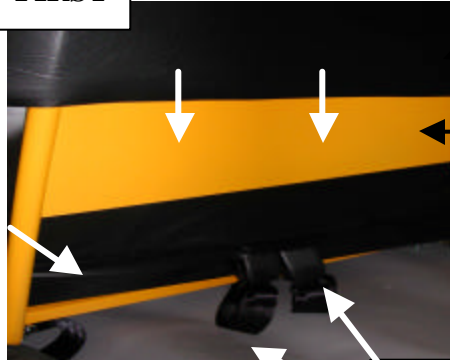

Slide SEAT CUSHION (42) over top of SEAT FRAME (72).

Push Seat Belts Through hole in Cushion.

**SECOND**

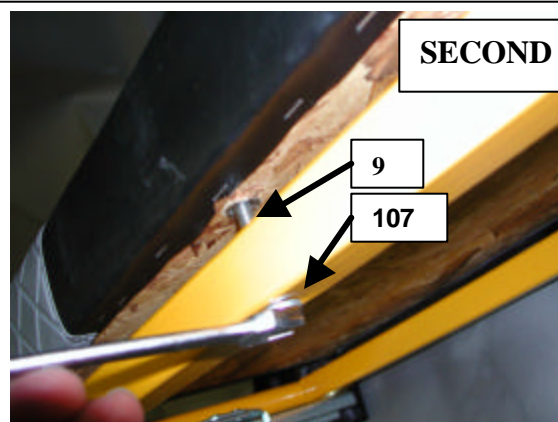

Attach bottom of SEAT CUSHION to SEAT FRAME using 1/4" Bolt (8) and 1/4" Lock Washer (107)

### CUSHION & SEAT ATTACHMENT

<u>Item #</u>	<u>Description</u>	<u>Qty</u>
9	BOLT; 1/4-20 X 1-3/4	1
42	CUSHION; SEAT	1
72	SEAT FRAME	1
107	WASHER; 1/4" LOCK	1

## SEAT ATTACHMENT

1. Align the **THREADED STUDS** (on the bottom of the Seat Assembly) with the **SEAT BRACKET HOLES** (on the FUN-KART FRAME).
2. Insert the **THREADED STUDS** into the **SEAT BRACKET HOLES**.
3. From UNDER the Gokart, secure the **SEAT ASSEMBLY** using four 5/16" **FLAT WASHERS** (99) and four 5/16" **NYLOCK NUTS** (58).

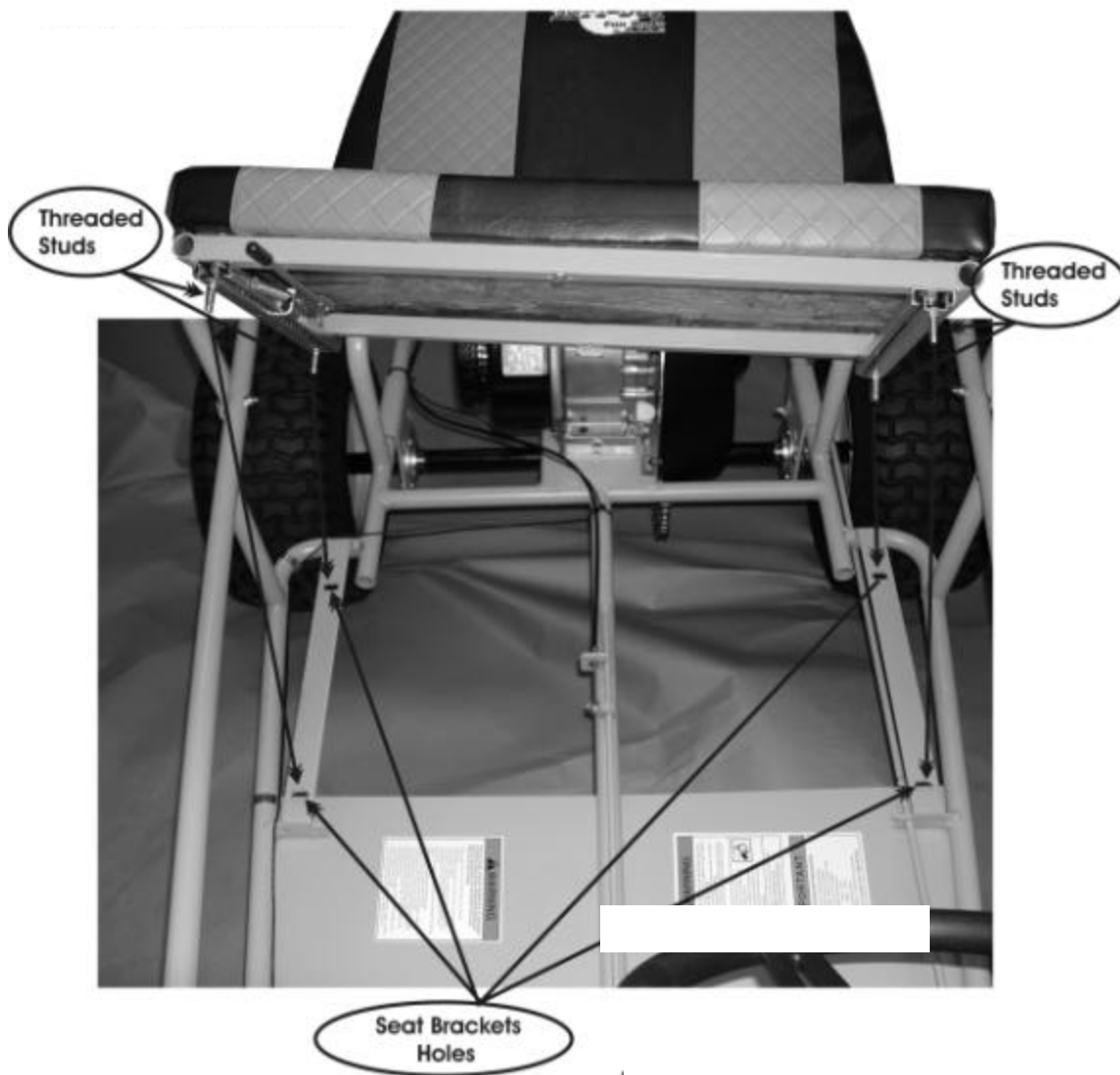



## 30032 (Yellow), 30033 (Blue), & 30034 (Red) BRUSH GUARD ASSEMBLY INSTRUCTIONS

1. Attach all parts of Brush Guards (*which include: Main, Front, Rear and Cross Brush Guards*) as shown on this page and the following page, **BEFORE** tightening bolts.
2. Do not over tighten the hardware attaching the ends of the shoulder belt. The BELT must rotate.

### BRUSH GUARD HARDWARE

<u>Item #</u>	<u>Description</u>	<u>Qty</u>
11	Bolt, 5/16-18 x 2"	1
21	Bolt, 5/16-18 x 1.50	11
33	Cable Tie; 23"	1
47	Flag, Safety	1
58	Nut, 5/16-18	12
80	Spacer, Black Plastic	1
99	Washer, 5/16, Flat	5

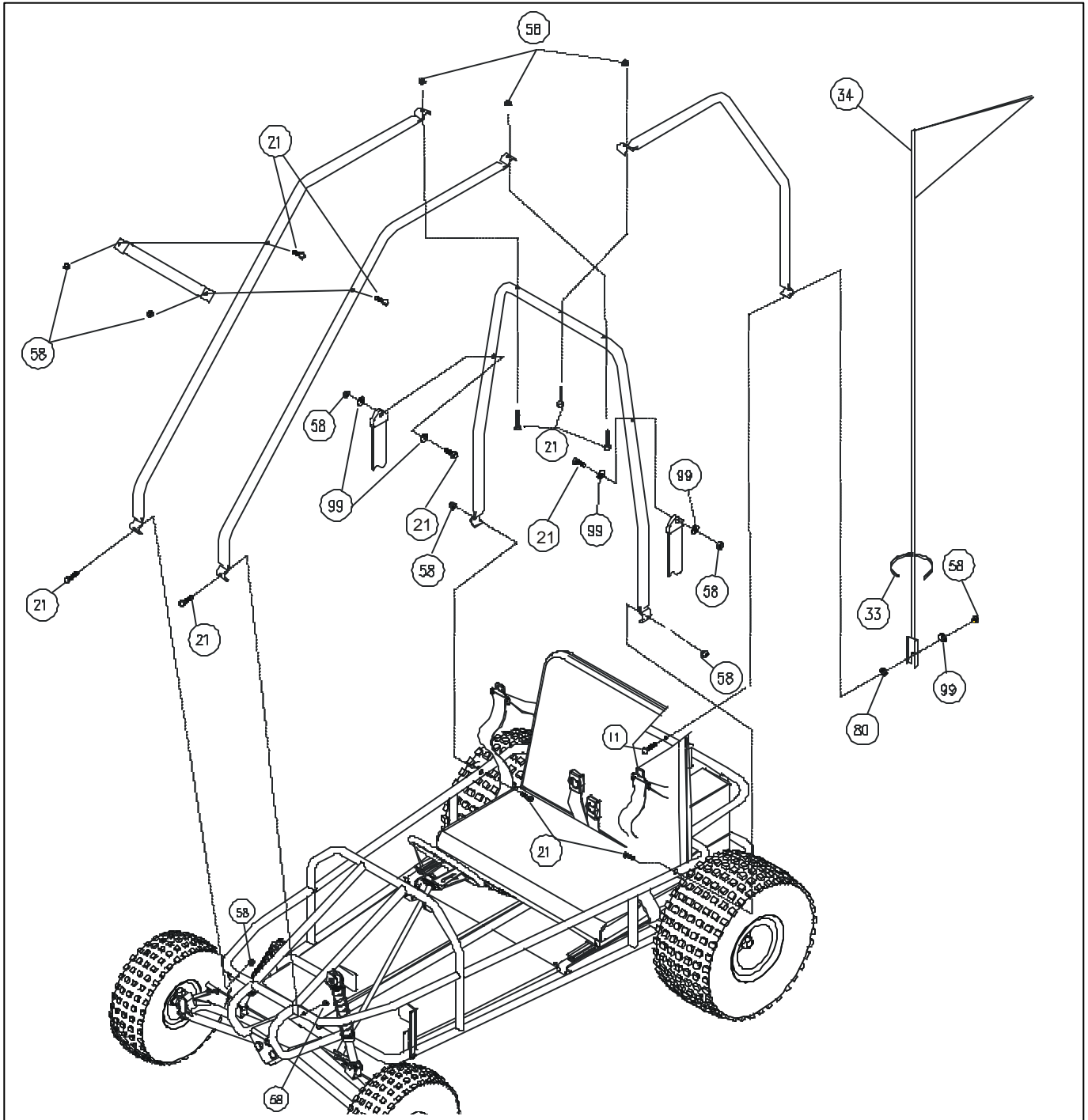

## 30032 (Yellow (ONLY!!!)) RACK ASSEMBLY INSTRUCTIONS

1. Attach the RACK to the GOKART FRAME by inserting a 1-1/2" Bolt through the GOKART FRAME and RACK.
2. Than secure each bolt with a 5/16" Nut

### RACK (30032 ONLY)

#### HARDWARE

<u>Item #</u>	<u>Description</u>	<u>Qty</u>
21	Bolt; 5/16-18x1.5	2
58	Nut; 5/16-18	2

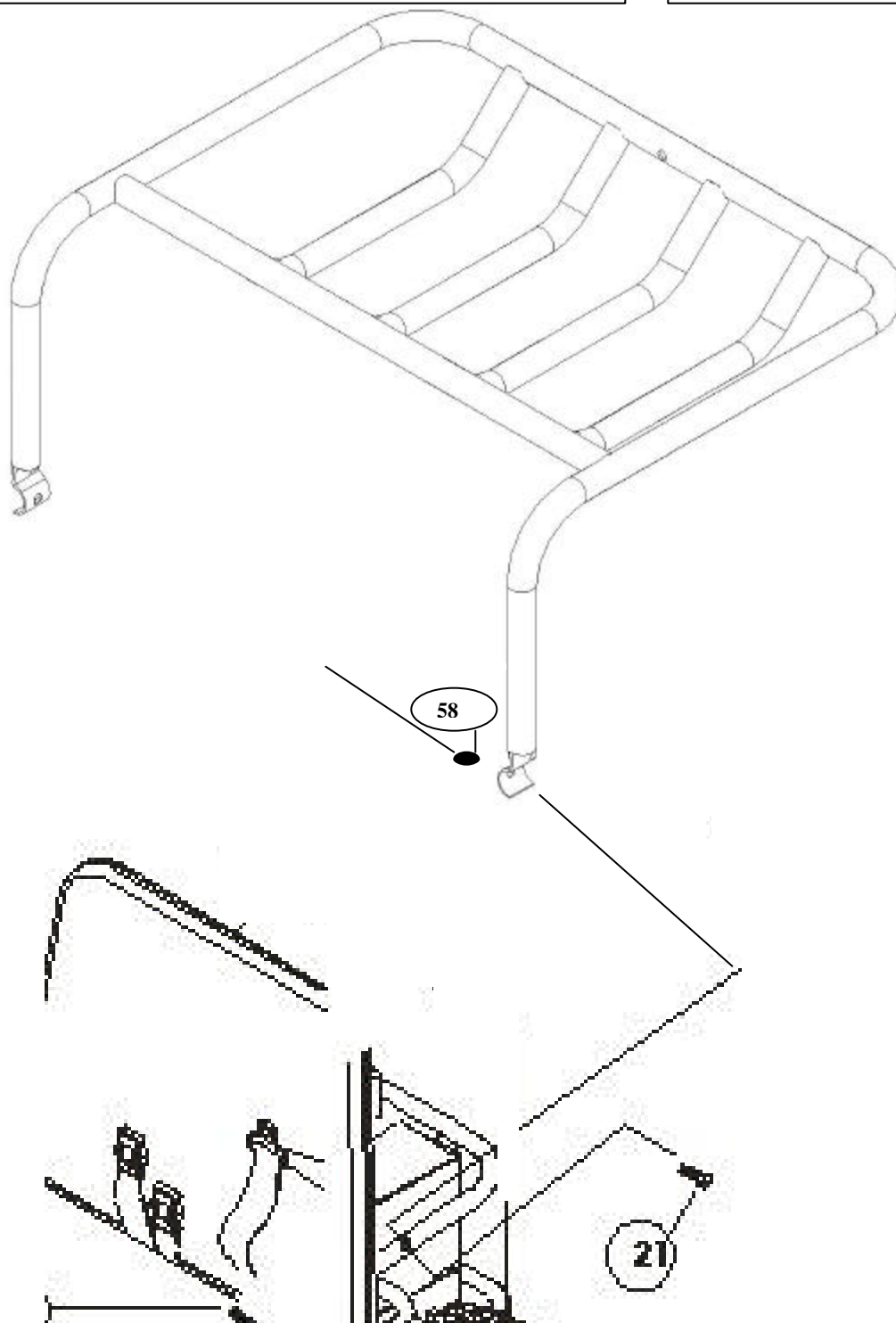



## **FOAM ATTACHMENT**

1. Cut FOAM (48) to fit length of each BRUSH GUARD as shown.
2. Finish splitting FOAM (48). (Foam is partially split)
3. Attach FOAM to the BRUSH GUARDS using CABLE TIES (32).

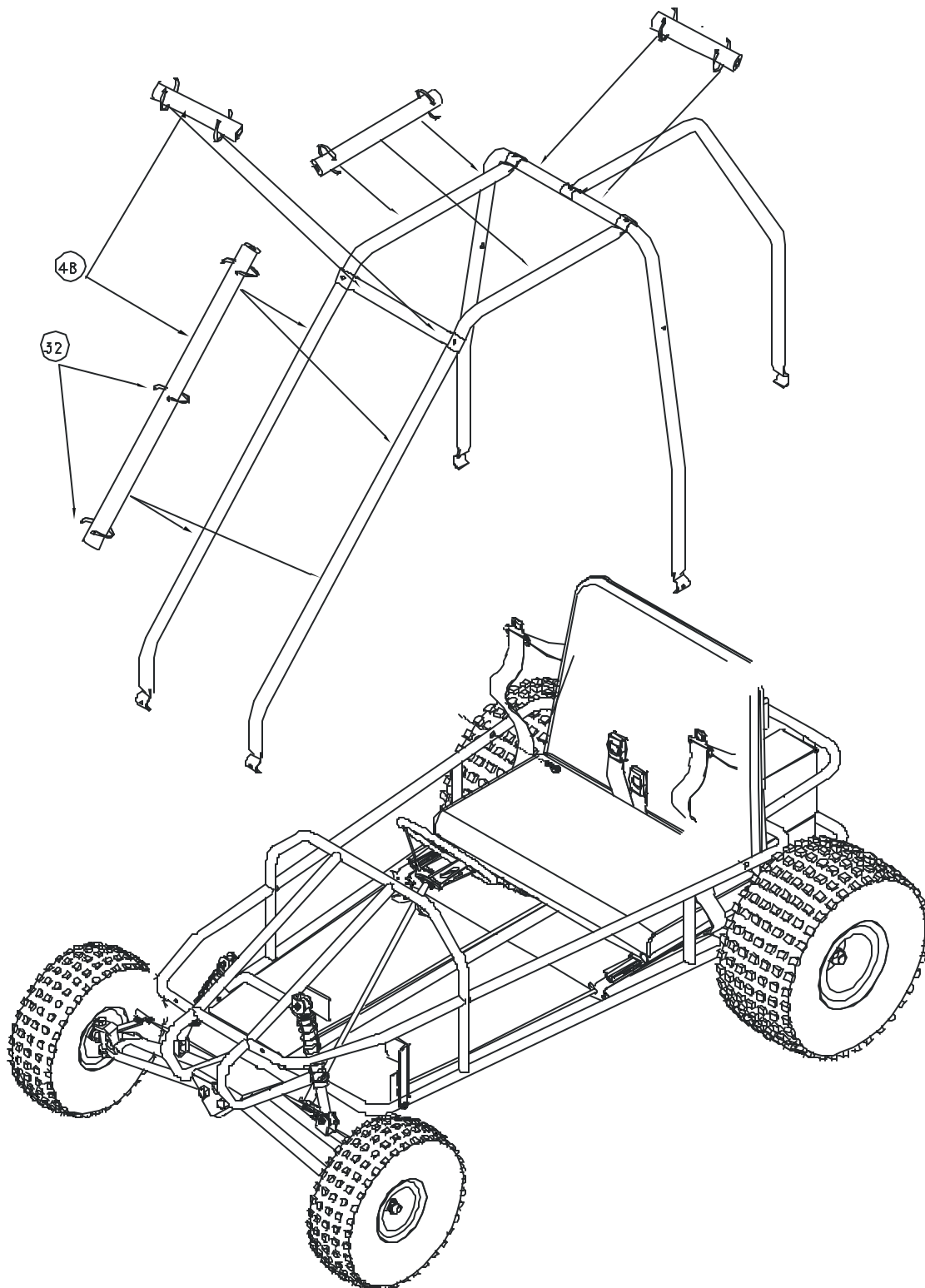

## **SUGGESTED DECAL APPLICATION**

Apply Decal kit as shown in the illustration below.

Note: The Decal shown in the illustration may NOT be the same Decal you received with your Yerdog Gokart. The placement of Decals are shown for the 30032 (Yellow) Gokart, but will be the same location for the 30034 (Red) Gokart with the exception of the Rear Decal (see below).

**Before application,**

1. Wipe surface with a clean cloth. Make sure surface is dry and free of dust and dirt.
2. Lay decal on floor pan to view the area it will cover.

**To apply decals,**

1. Peel from center of the backing to expose adhesive surface.

**NOTE: DO NOT REMOVE DECAL BACKING COMPLETELY.**

**This will cause decal to curl and stick to itself.**

2. Align the decal with floor pan. Gently press adhesive to floor pan to start application.
3. Slowly peel backing from underside of decal, gently pressing out any air bubbles. Continue until the decal is completely adhered to floor pan.
4. Use a cotton rag working in a circular motion to press out any air bubbles.
5. Attach other Decals as shown.



Place Decal on Rack for 30032 (Yellow) Gokart

Front Decal placement for both 30032 and 30033 Gokarts

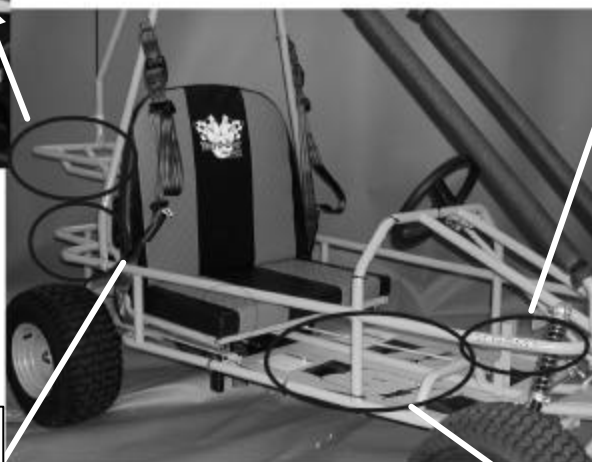
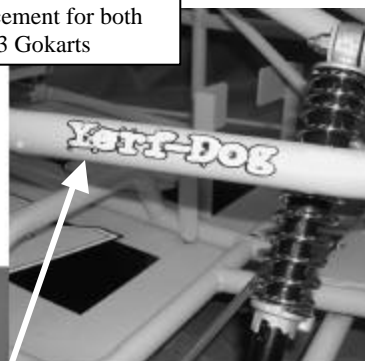

Place Decal on Engine Guard tube for 30034 (Red) Gokart.

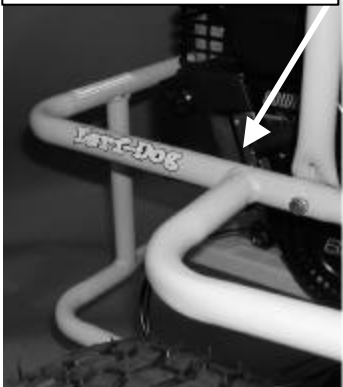

Place Decals on Belly Pan as shown for both 30032 and 30034 Gokarts. The Decal for the 30032 is shown below.



# **MODEL 30032 (YELLOW), 30033 (BLUE), 30034 (RED)**

## **REPLACEMENT PARTS IDENTIFICATION**

Item	Part No.	Description	Item	Part No.	Description
1	04247	A-ARM, LEFT, YELLOW, 30032	51	01067	KEY, ¼" X ¼" X 1"
	01758	A-ARM, LEFT, BLUE, 30033	52	H92250W	KEY, ¼" X ¼" X 2"
	01756	A-ARM, LEFT, RED, 30034	53	01134	KEY, 3/16" X 3/16" X 3.25"
2	04248	A-ARM, RIGHT, YELLOW, 30032	54	001203P	NUT, ¼-20 NYLOCK
	01757	A-ARM, RIGHT, BLUE, 30033	55	00995	NUT, 3/8-16 JAM
	01755	A-ARM, RIGHT, RED, 30034	56	001205P	NUT, 3/8-16 NYLOCK
3	01132	AXLE SHAFT	57	HH37524	NUT, 3/8-24, THIN NYLOCK
4	H93110W	BEARING RETAINER	58	HH1256T	NUT, 5/16-18 NYLOCK
5	H99502W	BEARING, 5/8" I.D.	59	01226	NUT, 5/16-18, JAM
6	H92010W	BEARING, 1" I.D.	60	HH62518	NUT, 5/8-18 THIN NYLOCK
7	Q43203W	BELT, DRIVE	61	HH10014	NUT;HEX;1-14;THIN;NYLOCK
8	22001400	BOLT, 1/4-20 X 1-1/2" HEX	62	27000100	PIN, SPRING
9	H32503W	BOLT, 1/4-20 X 1-3/4" HEX	63	04254	PITMAN ARM, YELLOW, 30032
10	H33137W	BOLT, 3/8-16 X 1" CARRIAGE		06100	PITMAN ARM, BLUE, 30033
11	04002	BOLT, 5/16-18 X 2" HEX		00322	PITMAN ARM, RED, 30034
12	H61610W	BOLT, 3/8-16 X 1" HEX	64	04064	RACK, YELLOW, 30032
13	22000300	BOLT, 3/8-16 X 1-3/4" HEX	65	02976	RETAINER, BRAKE BAND, ZINC
14	00920	BOLT, 3/8-16 X 2" CARRIAGE	66	H91470W	RING, 1/4" RETAINING
15	22000900	BOLT, 3/8-16 X 2" HEX	67	01528	RING, 1" RETAINING
16	01225	BOLT, 5/16-18 X 5/8" HEX	68	H32505W	SCREW, ¼-20 X ½" SELF-TAP HEX
17	H95188W	BOLT, 5/16-18 X ¾" CARRIAGE	69	H93200W	SCREW, ¼-24 X ¼" SET
18	H93290W	BOLT, 5/16-18 X 1-1/2" CARRIAGE	71	26000900	SEAT BELT, RETRACTABLE
20	H33135W	BOLT, 5/16-18 X 1-3/4" HEX	72	04054	SEAT FRAME; YELLOW, 30032
21	2200030	BOLT, 5/16-18 X 1-1/2" HEX		03262	SEAT FRAME, BLUE, 30033
22	H33136W	BOLT, 5/16-24 X ½" HEX		01617	SEAT FRAME, RED, 30034
23	H36254W	BOLT, 5/8-18 X 3-3/4" HEX	73	H92740W	SEAT RAIL PAIR
24	22001700	BOLT, 5/8-18 X 7" HEX	74	02972B	SHOCK ABSORBER, BLACK
25	H92130W	BRAKE BAND	75	00951	SLEEVE, 13-1/8" PVC
26	H92140W	BRAKE DRUM, 4" DIA.	76	00919	SLEEVE, 2-3/8" PVC
27	04267	BRAKE ROD, YELLOW, 30032	77	00983	SLEEVE, 4-5/8" PVC
	04328	BRAKE ROD, BLUE, 30033	78	01133	SPACER, DRIVE
	01638	BRAKE ROD, RED, 30034	79	00513	SPACER, SPINDLE

28	04062	BRUSH GUARD, CROSS, YLW, 30032	80	001467P	SPACER, BLACK PLASTIC
	04329	BRUSH GUARD, CROSS, BL, 30033	81	04268	SPINDLE, LEFT, YELLOW, 30032
	03149	BRUSH GUARD, CROSS, RED, 30034		04333	SPINDLE, LEFT, BLUE, 30033
29	04055	BRUSH GUARD, FRONT, YLW, 30032		02954	SPINDLE, LEFT, RED, 30034
	04330	BRUSH GUARD, FRONT, BL, 30033	82	04269	SPINDLE, RIGHT, YELLOW, 30032
	04261	BRUSH GUARD, FRONT, RED, 30034		04334	SPINDLE, RIGHT, BLUE, 30033
30	04060	BRUSH GUARD, MAIN, YLW, 30032		02955	SPINDLE, RIGHT, RED, 30034
	04331	BRUSH GUARD, MAIN, BL, 30033	83	H55030W	SPRING, COMPRESSION
	04264	BRUSH GUARD, MAIN, RED, 30034	84	H92541W	SPROCKET, 10 TOOTH
31	04058	BRUSH GUARD, REAR, YLW, 30032	85	23001100	SPROCKET, 60 TOOTH
	04332	BRUSHGUARD, REAR, BL, 30033	86	04270	STEERING SHAFT, YELLOW, 30032
	04262	BRUSHGUARD, REAR, RED, 30034		01637	STEERING SHAFT, BLUE, 30033
32	M12501W	CABLE TIE, 11"		04255	STEERING SHAFT, RED, 30034
33	M13501W	CABLE TIE, 23"	87	H92561W	STEERING WHEEL, 13"
34	M01001W	CABLE TIE, 3-1/4"	88	Q33100W	SWITCH, KILL
35	04265	CABLE, 40" THROTTLE	89	04271	THROTTLE ROD, YELLOW, 30032
36	00994	CHAIN, DRIVE		04335	THROTTLE ROD, BLUE, 30033
37	04071	CHASSIS, FRAME, YELLOW, 30032		01492	THROTTLE ROD, RED, 30034
	04323	CHASSIS, FRAME, BLUE, 30033	90	02063	TIE ROD, LEFT
	04260	CHASSIS, FRAME, RED, 30034	91	02064	TIE ROD, RIGHT
38	00204	CLIP, SPRING	92	46000030	TIRE, TURF TREAD, FRONT
39	H92690W	CLIP, WIRE	93	46000040	TIRE, TURF TREAD, REAR
40	03191	CLUTCH MOUNT ASSY; ZINC	94	Q43200W	TORQUE CONVERTER, DRIVEN
41	H91480W	COLLAR, 7/16 BORE X 7/8 O.D.	95	Q43201W	TORQUE CONVERTER, DRIVER
42	04196	CUSHION, SEAT, GRAY STRIPES, 30032	97	001616P	WASHER, 3/8" SPECIAL FLAT
	42000000	CUSHION, SEAT, 30033 / 30034	99	001618P	WASHER, 5/16" FLAT
43	04197	DECAL SET, 30032	100	H53132W	WASHER, 5/16" INTERNAL TOOTH
	62000600	DECAL SET, 30033	102	H56251W	WASHER, 5/8" NARROW FLAT
	00918	DECAL SET, 30034	103	00925	WIRE, 107" KILL SWITCH
44	02908	DRIVE COVER, PLASTIC	105	001474P	SCREW; SHEET METAL #10 x 1/2
45	02907	DRIVE COVER MOUNTING BRACKET	106	03152	CAP; VINYL; SCREW
46	Q43160W	ENGINE, 6.0 H.P. TECUMSEH	107	000710P	WASHER, 1/4" LOCK
47	H92700W	FLAG, SAFETY	108	01069	STEERING WHEEL CAP
48	M72038W	FOAM, BLACK TUBE		H91780W	MANUAL, ENGINE
49	04249	FOOT PEDAL, LEFT, YELLOW, 30032		04074	MANUAL, OWNERS, 30032 / 30034
	01760	FOOT PEDAL, LEFT, BLUE, 30033		02604	OIL; SAE 30; 20 OZ
	01762	FOOT PEDAL, LEFT, RED, 30034			
50	04250	FOOT PEDAL, RIGHT, YELLOW, 30032			
	01761	FOOT PEDAL, RIGHT, BLUE, 30033			
	01763	FOOT PEDAL, RIGHT, RED, 30034			

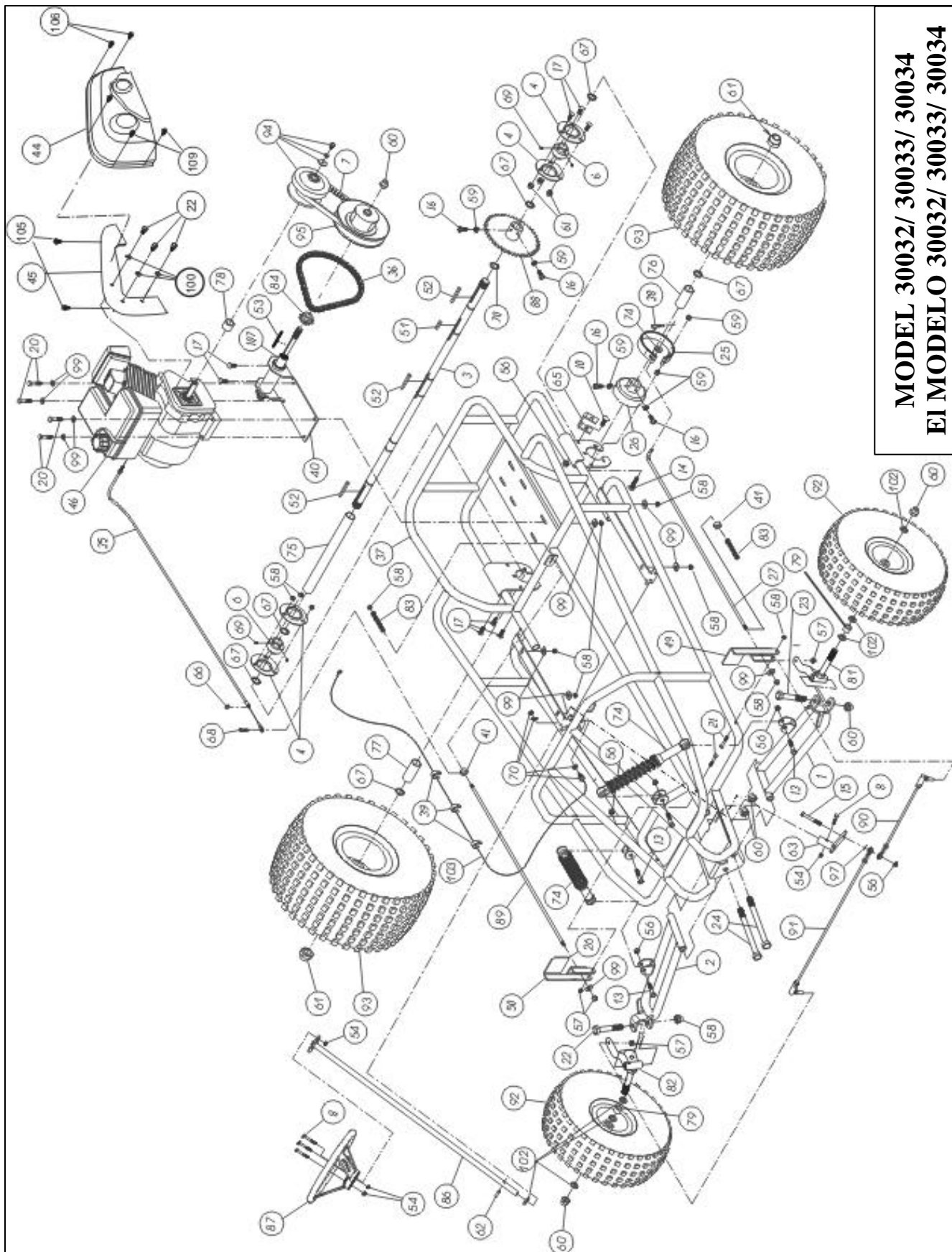

**MODEL 30032/ 30033/ 30034**  
**El MODELO 30032/ 30033/ 30034**

# SLOPE GUIDE

SIGHT AND HOLD THIS GUIDE LEVEL WITH A VERTICAL TREE, A CORNER OF A STRUCTURE, A POWER LINE POLE, OR A FENCE.

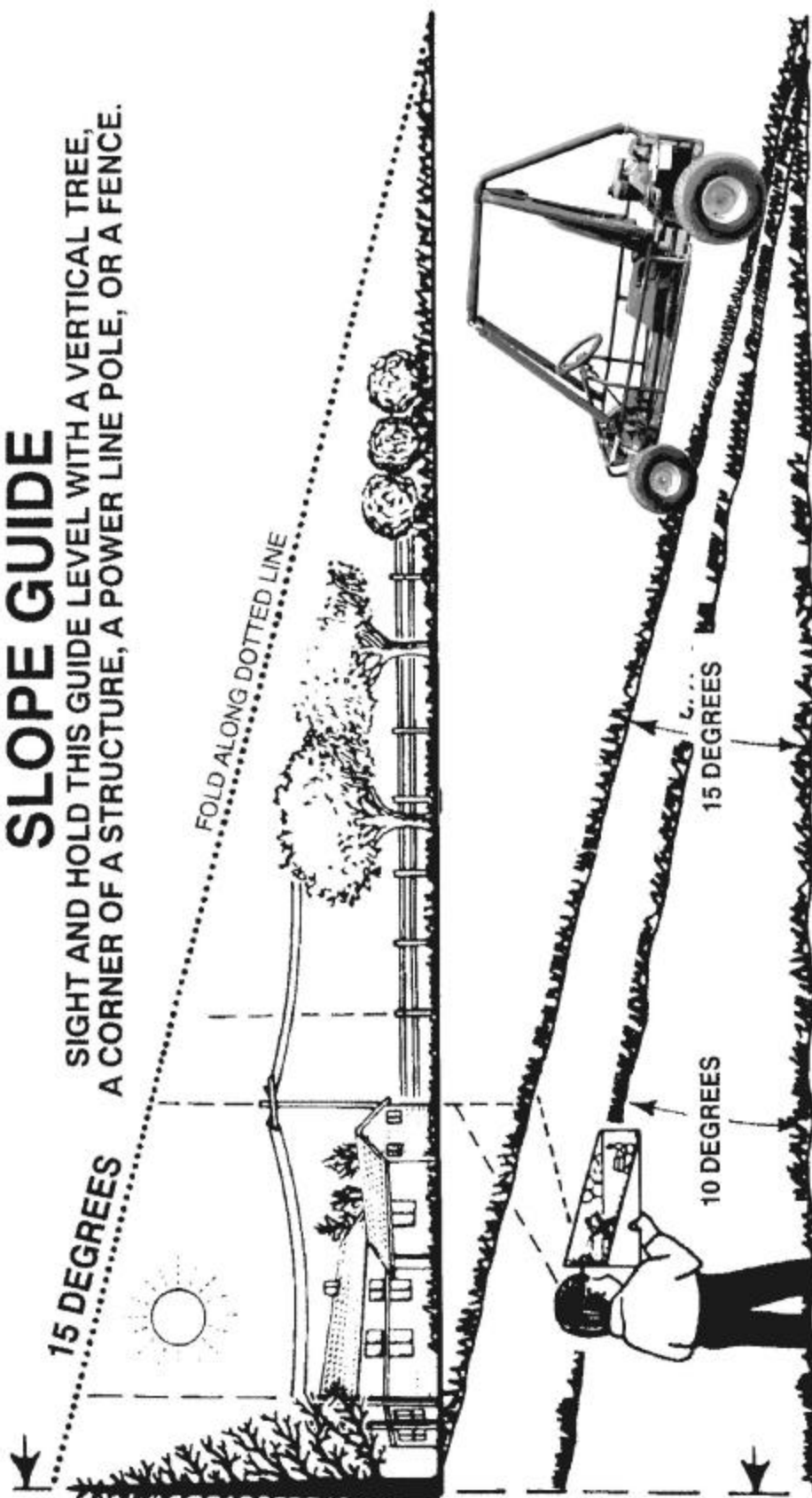

When operating your Fun Kart, do not ride a slope greater than 15 degrees. You can use this page to determine the angle of the slope. A 15 degree slope is generally safe to ride up and down. However, if you do not feel safe or if you are not completely sure, use this guide and do not ride a slope that is greater than 15 degrees.

A 15 degree slope is a hill that increases in height at approximately 2.5 feet in 10 feet.

A 10 degree slope is a hill that increases in height at approximately 1.7 feet in 10 feet.

**!** Use extreme care at all times, and **AVOID SUDDEN TURNS OR MANEUVERS**. Follow other instructions in this manual for safety in riding on slopes. Operate a Fun Kart up or down slopes, never across the face of slopes. Use extra care when operating on or near slopes and obstructions.

# VEHICLE REGISTRATION AND WARRANTY CONFIRMATION

## **IMPORTANT!**

*Please return this information with proof of purchase, within 10 days of purchase, to validate your warranty .*

*Return to:*

**F.F. Acquisition Corp.  
YERF-DOG Warranty Dept.  
1743 South Horne # 100  
Mesa, AZ 85204**

Thank you for purchasing this fine YERF-DOG product. With proper use, maintenance and service this kart will bring many years of fun and enjoyment. Please complete this vehicle registration and warranty confirmation form to ensure protection under the terms and conditions of the warranty and to verify ownership of this product.

To ensure maximum safety while operating your YERF-DOG Fun Kart, observe the following precautions:

**OPERATE THIS KART OFF ROAD ONLY  
ADULT SUPERVISION FOR OPERATORS UNDER 16 YEARS OLD  
WEAR A D.O.T. APPROVED HELMET, PROTECTIVE EYE WEAR, AND CLOTHING  
SECURE LONG HAIR AND LOOSE CLOTHING; KEEP ARMS, LEGS, AND FEET INSIDE THE KART  
DO NOT OPERATE UNDER THE INFLUENCE OF DRUGS OR ALCOHOL**

To ensure maximum owner satisfaction and understanding of this product, you should:

**READ OWNERS MANUAL BEFORE OPERATING KART  
REVIEW AND FULLY UNDERSTAND THE KART AND ENGINE WARRANTIES  
INSPECT THE KART UPON DELIVERY  
SECURE A COMPLETED COPY OF THIS CERTIFICATE FOR YOUR RECORDS**

In signing this document, the purchaser acknowledges that he/she understands the warranty limitations, safety, and maintenance guidelines outlined above and in the owner's manual and, therefore, agrees that all riders/operators will adhere to these specifications.

\_\_\_\_\_  
Model No.

\_\_\_\_\_  
Serial No.

\_\_\_\_\_  
Date of Purchase

\_\_\_\_\_  
First Name

\_\_\_\_\_  
Initial

\_\_\_\_\_  
Last Name

\_\_\_\_\_  
Street Address

\_\_\_\_\_  
City

\_\_\_\_\_  
State

\_\_\_\_\_  
Zip Code

\_\_\_\_\_  
Home Telephone Number

\_\_\_\_\_  
Parent's Signature

**(Please enclose a copy of your proof of purchase.)**