

Powered Personal Transportation

---

Electric Power Board



## Product Handbook

**FOR THE BLADEZ  
ION 450  
ELECTRIC POWER BOARD**

PLEASE BE SAFE WHEN RIDING . . .  
ALWAYS WEAR A HELMET AND OBEY ALL LAWS!





# IMPORTANT



## **BATTERY MAINTENANCE and CHARGING INSTRUCTIONS**

1. You **MUST** Charge your scooter completely prior to initial use.  
(Follow charging instructions in your Product Handbook).
2. Charge immediately after every use.
3. Charge before storage. You must charge every 30 days if not in use.
4. Only use the charger provided.
5. **DO NOT** allow your unit to Deep Discharge.
6. For safety purposes, **DO NOT** charge for over 24 hours.
7. Turn the unit **OFF** when not in use.

**Failure to follow proper CHARGING INSTRUCTIONS will  
VOID YOUR WARRANTY!**

**This PRODUCT IS NOT INTENDED FOR EXTREME or  
OFF-ROAD Use! Please take care of your POWERBOARD!**

**DO NOT JUMP or ABUSE THIS PRODUCT!**

**DO NOT RIDE IN WET CONDITIONS!**

**Failure to follow these instructions will  
VOID YOUR WARRANTY!**

If you have any questions, please contact Bladez Customer Service  
(866) 325-2339 or visit us on the web at [www.ebladez.com](http://www.ebladez.com).

# IMPORTANT

## PLEASE READ THIS BEFORE USING THIS PRODUCT

### **WARNING**

This product does not conform to Federal Motor Vehicle Standards and is not intended for operation on public streets, roads or highways. Serious injury can result from the unsafe operation of this product. The operator can minimize these risks by using certain safety equipment such as: safety helmet, goggles, gloves, elbow and kneepads and appropriate footwear.

DO NOT operate this product in traffic, on wet, frozen oily or unpaved surfaces or under the influence of drugs and/or alcohol. Avoid uneven surfaces, potholes, surface cracks and obstacles.

DO NOT use a water hose to clean this product. See Product Handbook for more information.

This product is recommended for riders 16 YEARS OF AGE and older.

### **SAFETY**

- This product should not be used by persons without excellent vision, balance, coordination, reflex, muscle and bone strength and good decision-making capabilities.
- This product should not be used by minors without adult supervision.
- This product should not be used by persons unwilling or unable to take responsibility for their own actions.
- The user of this product assumes ALL risks associated with its use. To minimize these RISKS, the user must wear safety helmet, goggles, gloves, elbow and knee pads and appropriate footwear.
- This product is ELECTRIC! DO NOT Ride this product in wet conditions, puddles or rainy weather.

**DO NOT TAKE YOUR  
BLADEZ POWERBOARD BACK  
TO THE STORE!  
CONTACT US FIRST**

IF YOU HAVE ANY QUESTIONS OR NEED  
ASSISTANCE,  
PLEASE CALL BLADEZ, TOLL FREE AT:

(866) EBLADEZ  
(866) 325-2339

MONDAY thru FRIDAY, 8am to 5pm PST  
or visit us on the web at:

[www.ebladez.com](http://www.ebladez.com)

## NATIONWIDE NETWORK OF SERVICING DEALERS



**FOR ALL YOUR POWERBOARD NEEDS**

## **TABLE OF CONTENTS**

<b>BATTERY MAINTENANCE AND CHARGING INSTRUCTIONS.....</b>	<b>1</b>
<b>GETTING TO KNOW YOUR BLADEZ POWER BOARD .....</b>	<b>5</b>
<b>BOX CONTENTS.....</b>	<b>6</b>
<b>GETTING STARTED .....</b>	<b>6</b>
<b>TIRE INFLATION.....</b>	<b>8</b>
<b>CHARGING SYSTEM.....</b>	<b>8</b>
<b>RIDING .....</b>	<b>9</b>
<b>FOLDING AND STORAGE .....</b>	<b>10</b>
<b>RECOMMENDED TOOLS.....</b>	<b>11</b>
<b>BRAKING SYSTEM.....</b>	<b>11</b>
<b>TIRES AND WHEELS .....</b>	<b>11</b>
<b>CHAIN CARE .....</b>	<b>12</b>
<b>CLEANING .....</b>	<b>13</b>
<b>TROUBLESHOOTING GUIDE .....</b>	<b>14</b>
<b>OTHER QUESTIONS .....</b>	<b>14</b>

## GETTING TO KNOW YOUR BLADEZ POWER BOARD

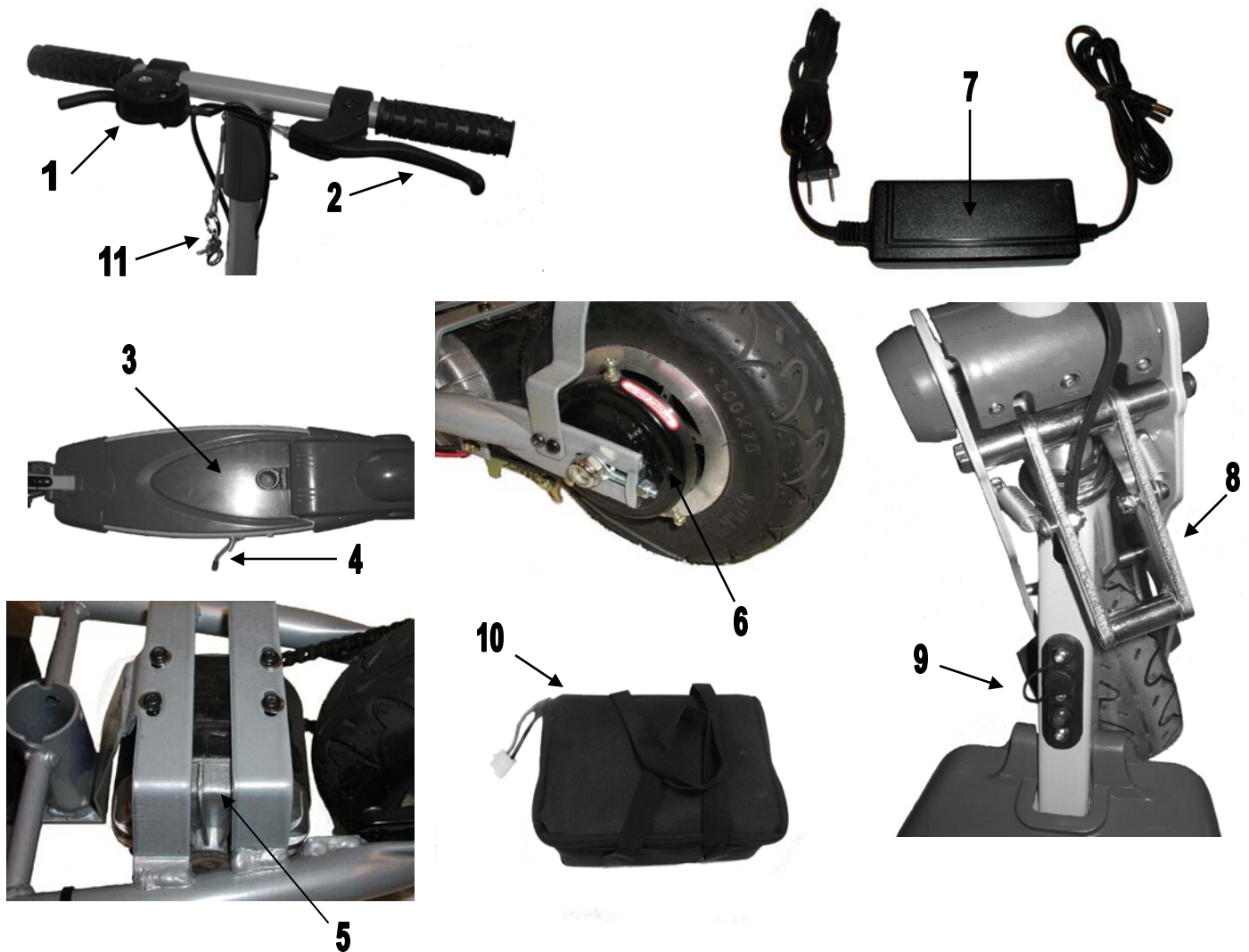

Before operating your Bladez ION 450 ELECTRIC POWERBOARD, please familiarize yourself with the following features:

- |                       |                                       |
|-----------------------|---------------------------------------|
| 1. Accelerator Lever  | 7. 1.6A Charger                       |
| 2. Brake Lever        | 8. Folding Handle                     |
| 3. Quick Release Deck | 9. On/Off Switch & Power/Charging LED |
| 4. Kickstand          | 10. Battery Pack                      |
| 5. Motor              | 11. Handlebar Clip                    |
| 6. Rear Drum Brake    |                                       |

## **BOX CONTENTS**

Your Bladez ION 450 should come complete with:

1. Bladez **ION 450 ELECTRIC POWERBOARD**
2. AC Wall Charger
3. 3mm/4mm/5mm Allen wrenches / 8mm/10mm/14mm wrenches
4. Product Handbook and Registration Card
5. Handlebar mounting hardware

## **GETTING STARTED**

**YOUR SCOOTER WILL COME CHARGED OUT OF THE BOX BUT YOU MUST CHARGE YOUR ION 450 FOR 6-8 HOURS EVEN IF THE LIGHT ON THE SCOOTER IS FLASHING GREEN WHEN YOU PLUG THE CHARGER IN PRIOR TO FIRST USE!**  
(See page 8)

### **Before you Ride**



**FIG A**

### **Attach the Handlebars**

1. Insert the handlebar stem into the top of the steering tube (Fig. A), with the throttle lever to the right. Lower the handlebar stem and line up the holes with the holes in the steering tube.



**FIG B**

2. Place the 2 plastic covers on the steering tube (Fig. B). Line up the holes in the plastic covers with the holes in the handlebar stem and steering tube.

**Plastic Covers**



**FIG C**

3. Place the handlebar clip and the washer onto the longer of the two bolts (Fig. C).

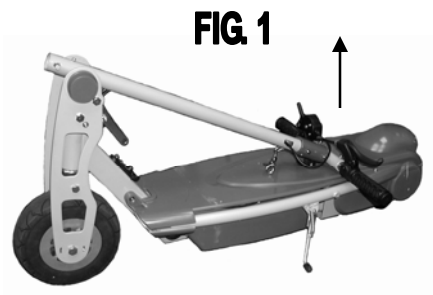



**FIG. D**

4. Insert the bolt with the handlebar clip into the top hole and push through the steering tube. Insert the other bolt into the lower hole and push through the steering tube. Secure the bolts with the two acorn nuts (Fig. D).

### **Unfolding**



**FIG. 1**

1. To unfold your ION 450, hold the unit with one hand, while gently pulling up on the handlebars with the other. (FIG. 1)

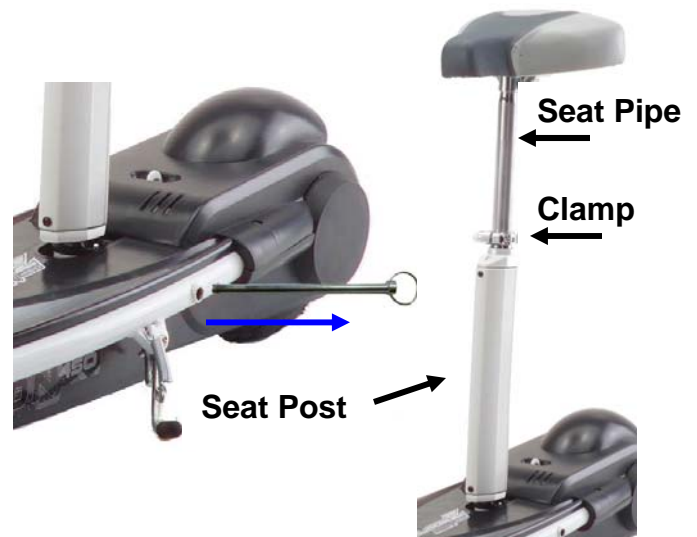

**FIG. 2**

2. Fully extend the handlebars to their upright position until you feel the mechanism lock into place. (FIG. 2)

### **Integrated Seat Base**

The ION 450 comes with a seat base built in to the scooter. Having this base built in to the scooter will make it easy to install and uninstall the seat quickly and easily. To install the seat, remove the pin from the side of the scooter. Then place the seat post into the base on the deck. Replace the pin in the side of the scooter to secure the post. Place the seat on the seat





pipe and adjust to your preference and tighten the nut on the underside of the seat. You may now adjust the seat to your preferred height by moving the seat pipe up or down. Lock in place with the clamp.

## **TIRE INFLATION**

Make sure the front and rear tires are inflated to **35 P.S.I.** as tires may lose pressure during shipping. For information on inflating tires, please refer to page 11.

\* Note: It is not advisable to operate your Power Board on low tire pressure. This will negatively affect speed, handling and performance.

## **CHARGING SYSTEM**



The ION 450 comes with a 1.6A charger. (FIG. 3) Make sure the unit is turned OFF. To charge your scooter you must plug the charger adapter into the charging jack on the scooter (FIG. 4) and plug the charger into the wall. The LED light on the scooter will let you know the status of the batteries while they are charging. A flashing RED LED indicates that the charging cycle has started. When the LED changes to flashing GREEN, the batteries are fully charged.



\*Note: Full charging takes approx. 6-8 hours from full discharge. It is recommended that you charge your Power Board after each use.

To charge batteries externally, purchase the hot swappable battery pack from your local dealer or from us here at Bladez. Go to [www.ebladez.com](http://www.ebladez.com) or call us at 866-325-2339.

\*It is recommended that the initial charge out of the box should be for 6-8 hours even if the LED on the scooter is flashing GREEN when you plug the charger in.

## **Tips for Extending Battery Life**

1. You **MUST** charge completely prior to initial use. Charge completely before storage and approximately every 30 days if not in use.
2. Charge immediately after every use.
3. **DO NOT** allow your Power Board to discharge completely. Recharging when batteries are still at partial capacity helps to extend battery life.
4. For safety purposes, **DO NOT** charge for over 24 hours.
5. Turn the unit **OFF** when not in use.

## **RIDING**

**NOTE:** If the unit is at the ON position for over 10-15 minutes without moving, Smart Power will shut the scooter OFF. To turn the scooter back on, simply press the ON/OFF button again.

1. Make sure that all of the bolts and screws are tightened.
2. Raise the kickstand to its upright position.
3. PRESS THE ON/OFF Button once. (FIG. 5) The LED light will blink RED and then turn GREEN (indicating the ION 450 is ON and ready to ride).

**FIG. 5**



4. Put one foot on the deck of the ION 450. After pushing off with the other foot, gently squeeze the ACCELERATOR LEVER on the right side of the handlebars. The Power Board will begin to move on its own power.
5. Your ION 450 has a variable speed throttle lever. You can control the speed of your scooter by the amount of pressure you use when depressing the throttle lever. The more you depress the throttle the faster you will go.
6. To stop, release the accelerator handle and depress the BRAKE LEVER (on the left side of the handlebars).
7. When you feel your Power Board moving slow, sluggish or running out of power, it is time to recharge. (See charging instructions)
  - Note: DO NOT allow the batteries to fully discharge. This can damage the batteries and prevent them from taking a full charge.

## **Quick Release Deck**

**FIG. 6**      **Lift Here**



The ION 450 is equipped with a quick release deck to make it easier to get to the batteries and the pc board. To open the deck, lift the rear of the deck up. (FIG. 6)

## **Batteries**

**FIG. 7**

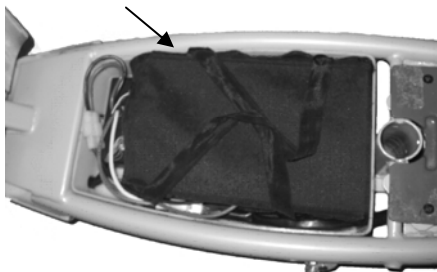

The ION 450 comes with 2 12V-10Ah batteries. The batteries come in a pack that is located under the deck. The battery pack has one set of wires coming out of the bag. (FIG. 7) This wire is connected to the pc board. The battery pack can also be removed from the scooter and charged separately when you purchase the hot swappable battery pack which includes the charging adapter.

## **FOLDING AND STORAGE**

**FIG. 8**



When you are done riding the ION 450 you can fold it down for compact storage, carrying and transportation.

2. To fold down the ION 450, use one hand to pull up on the FOLDING HANDLE, while using the other to gently pull down on the handlebars. (FIG. 8) BE CAREFUL NOT TO HIT YOUR HEAD WITH THE HANDLEBAR.

**FIG. 9**



3. Lock the unit into the folded position by securing the handlebar clip to the metal loop on the deck. (FIG. 9)

You can now carry the ION 450 by the handlebar tube.

## **RECOMMENDED TOOLS**

To adjust and service the Bladez ION 450 Power Board the following additional tools may be helpful:

- **Allen Keys:** 6mm.
- **Wrenches:** 16 / 17mm Open and ring combination.
- **Philips & Flat Head Screwdrivers**
- **Hand bicycle pump**
- **Oil, Grease or Lubricant (such as WD-40)**

## **BRAKING SYSTEM**

The ION 450 uses a rear wheel drum brake system activated by a hand lever (on the left side of the handlebar). The brake is activated by squeezing the BRAKE LEVER with your left hand. The ION 450 is equipped with a controller that temporarily disengages the power to the motor when the BRAKE LEVER is depressed.

Practice braking on a smooth, dry surface to get used to the feel of the braking system. Braking distance is affected by wet conditions and loose and uneven riding surfaces.

The brakes are relatively maintenance free and come adjusted to the proper setting from the factory.

## **TIRES AND WHEELS**

It is recommended that front and rear tires be inflated to **35 P.S.I.** During shipping, the tires might become slightly deflated.

### **To Inflate the Tires**



**FIG. 10**

1. Remove the valve stem cover to expose the valve stem. (FIG. 10, 11)
2. Using a standard bicycle pump, inflate the tires to **35 P.S.I.** and replace the valve stem cover. It is also recommended to use a tube additive like **Slime** available from any motorcycle shop, to avoid inconvenient punctures.



**WARNING: Injury can occur if you fail to release the air from the tire.**

The Bladez ION 450 uses an identical rim and tire assembly for the front and rear

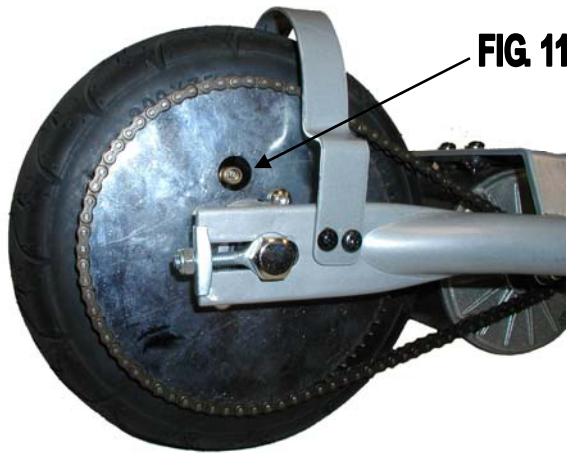

wheels. The wheels are actually two wheel halves (split rim) bolted together to make it easier to remove and replace the tires and tubes. **CAUTION:** Empty all air from the tire prior to loosening the bolts to split the rim as the split rim is under considerable pressure while the tire is inflated.

Tire wear will vary based on rider weight, riding conditions and care. Replacement tires and tubes can be obtained at your local Bladez dealer, through motorcycle shops, from the Bladez website at [www.ebladez.com](http://www.ebladez.com) or by calling Bladez at (866) 325-2339. The Bladez ION 450 uses a 200x75 pneumatic tire on the front and rear.

## **CHAIN CARE**

Proper chain care will increase the life and improve performance of your Power Board. Always keep the chain lubricated and tightened to proper tension.

### **Lubrication**

Always keep the chain lubricated with a good chain spray or grease (not chain wax). If the chain is allowed to run dry for a prolonged period of time it will fail, and the life of the chain is severely shortened.

### **Chain Adjustment**

The chain on the ION 450 may need to be adjusted from time to time. The chain should be tight enough not to skip, but have a little bit of play. If you feel your chain skipping or make a popping noise, adjust the tension immediately.

**For regular adjustments:**

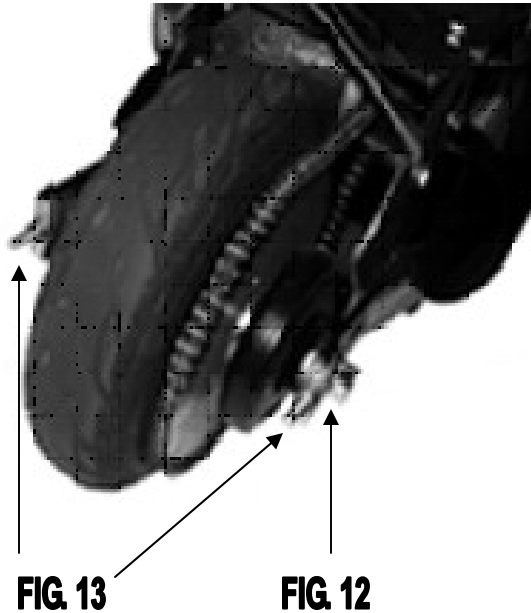

1. Using a 17mm wrench, loosen the axle bolt on the rear wheel. (FIG. 12)
2. While the axle bolt is loose, using a 10mm wrench loosen the tension bolts behind the rear wheel of the ION 450 and move the rear wheel backwards to remove the slack from the chain. (FIG. 13)
3. Once this is achieved the wheel nuts must then be relocked into position and wheel alignment must be checked (while turning the wheel, visually check that the area between the wheel and the frame parts have clearance).

**\*Note: Chains that are run excessively dry or loose can result in sprocket teeth being severely damaged.**

## **CLEANING**

Use a soft cloth dampened with warm water to clean your scooter. Do not use a hose or directly spray the scooter with water as it will damage the electrical equipment and void your warranty.

## **TROUBLESHOOTING GUIDE**

The following guide will help assist you in identifying and correcting common problems with your ION 450:

<b>Symptoms</b>	<b>Potential Causes:</b>	<b>Solutions:</b>
The Led light on the scooter flashes GREEN right away.	THIS IS NOT A PROBLEM! Most Bladez scooters come charged out of the box.	Charge your scooter for an additional 6-8 hours prior to initial use.
Charger is plugged in, but the light keeps flashing RED.	This is part of the normal charging procedure. It may take 6-8 hours for the LED to flash GREEN indicating the batteries are fully charged.	Continue charging the scooter until the LED flashes GREEN.
The ION does not hold a charge long enough.	The sealed Lead Acid batteries have reached the end of their useful life and will need to be replaced.	Replace batteries. Call Bladez at (866) 325-2339 for replacement Information. Or visit us on the Web at: <a href="http://www.ebladez.com">www.ebladez.com</a>
My ION 'sputters' or accelerates very slowly.	Your batteries are running out of charge.	Recharge your ION.
Unit is fully charged (LED flashing GREEN), but unit will not run.	Possible bad PC board.	Contact Bladez Customer Service for assistance at (866) 325-2339.

## **OTHER QUESTIONS**

Where can I get replacement and aftermarket parts?

From your local Servicing Dealer or by calling Bladez at:

(866) 325-2339

Or from the Bladez Web Site at:

[www.ebladez.com](http://www.ebladez.com)

For additional questions, service instructions, further information and important phone numbers, please go to the Bladez website at [www.ebladez.com](http://www.ebladez.com) or call Bladez Customer Service at (866) 325-2339.

Thank you for purchasing a Bladez Power Board and please tell your friends about how much fun you have on your Bladez Power Board.





[www.ebladez.com](http://www.ebladez.com)

Bladez, Corp.  
20155 Ellipse  
Foothill Ranch, CA  
**92610**